

CURRENT SENSOR KIT

IMPORTANT: This document guides our dealers, boatbuilders, and company service personnel in the proper installation or service of our products. If you have not been trained in the recommended servicing or installation procedures for these or similar Mercury Marine products, have the work performed by an authorized Mercury Marine dealer technician. Improper installation or servicing of the Mercury product could result in damage to the product or personal injury to those installing or operating the product. Always refer to the appropriate Mercury Marine service manual for component removal and installation instructions.

NOTE: After completing installation, place these instructions with the product for the owner's future use.



60616

Ref. No.	Qty.	Description
a	1	Current sensor
b	1	Adapter harness
c	1	Extension harness

Steering Current Sensor Installation

NOTE: The current sensor may be connected anywhere on the positive cable that is convenient to the installer.

1. Disconnect the power steering pump from the battery.
2. Install current sensor anywhere on the positive cable that is convenient as shown in the following examples.

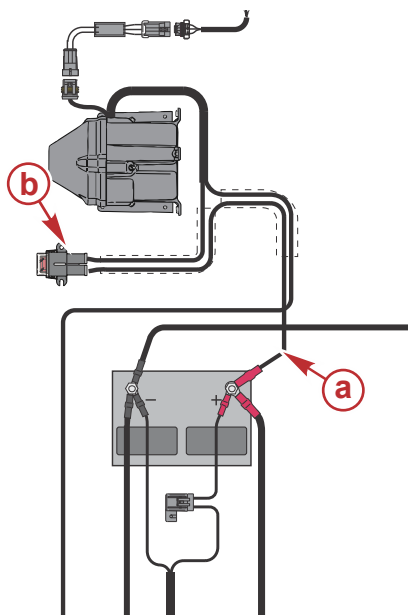

64358

Dual and triple application

- a** - Positive cable (current sensor can be connected anywhere on the positive cable that is convenient to the installer)
- b** - Fuse for power steering pump

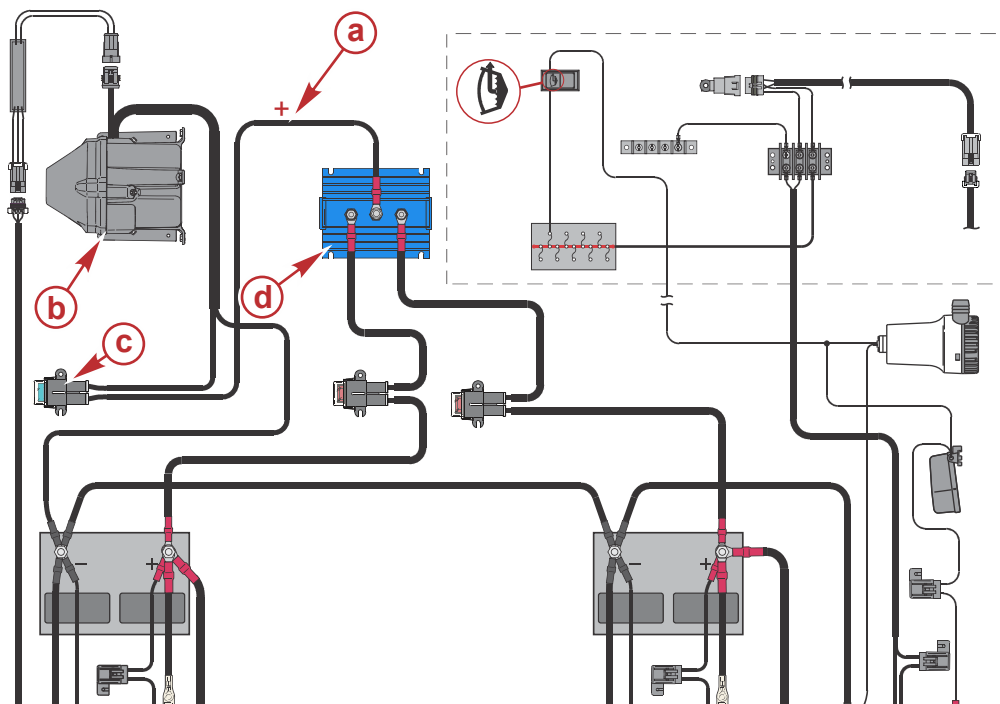

64359

Quad engine with automatic power switch (APS)

- a -** Positive cable (current sensor can be connected anywhere on the positive cable that is convenient to the installer)
- b -** Power steering pump
- c -** Fuse
- d -** Automatic power switch (APS)

3. Connect the adapter harness to the current sensor and to the extension harness. Extension harnesses are available if the mounting location of the sensor is greater than 3 m (10 ft) from the TVM.

Description	Part Number
1.5 m (5 ft) extension harness	8M0122787
3 m (10 ft) extension harness	864988
4.6 m (15 ft) extension harness	8M0122618
6 m (20 ft) extension harness	8M0122619

4. Route the steering pressure sensor harness to the corresponding thrust vector module (TVM). Secure the harness as necessary to keep it from interfering with moving components.

5. Connect the 4-pin connector on the adapter harness to the TVM.

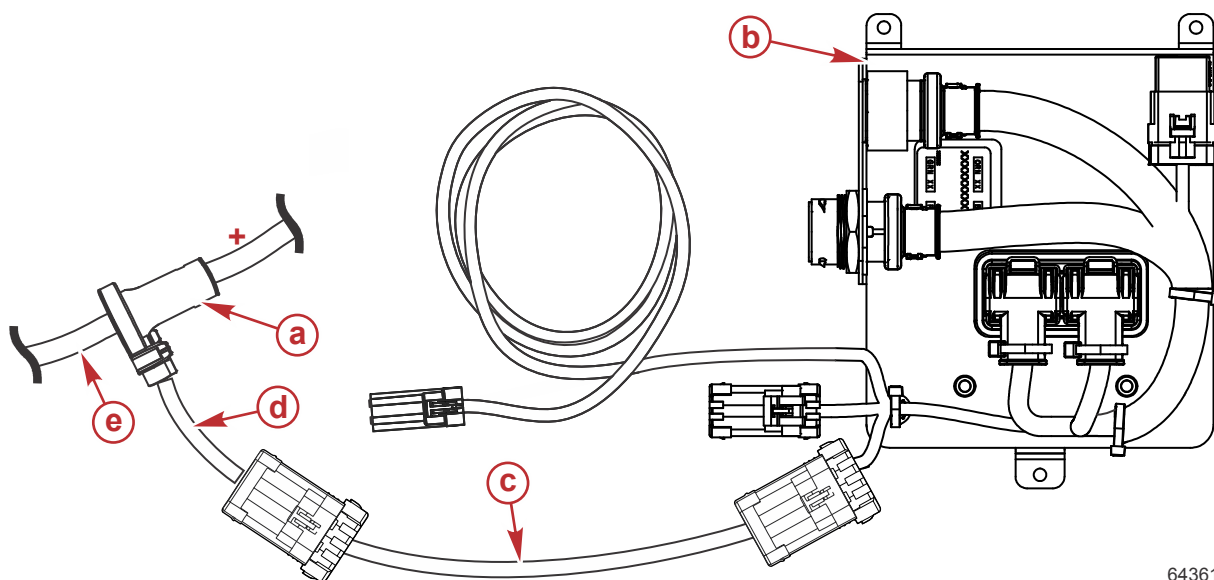

- a** - Current sensor
- b** - TVM
- c** - Extension harness
- d** - Adapter harness
- e** - Positive cable for power steering pump

64361

Products of Mercury Marine
W6250 Pioneer Road
Fond du Lac, WI 54936-1939

© MERCURY MARINE. All rights reserved. Reproduction in whole or in part without permission is prohibited. Alpha, Axis, Bravo One, Bravo Two, Bravo Three, Circle M with Waves Logo, K-planes, Mariner, MerCathode, MerCruiser, Mercury, Mercury with Waves Logo, Mercury Marine, Mercury Precision Parts, Mercury Propellers, Mercury Racing, MotorGuide, OptiMax, Quicksilver, SeaCore, Skyhook, SmartCraft, Sport-Jet, Verado, VesselView, Zero Effort, Zeus, #1 On the Water and We're Driven to Win are registered trademarks of Brunswick Corporation. Pro XS is a trademark of Brunswick Corporation. Mercury Product Protection is a registered service mark of Brunswick Corporation.