

# REMOTE CONTROL ATTACHMENT KIT

## MERCURY/MARINER P/N 880093A2

### 50/60 4-STROKE

#### Components Contained in Kit

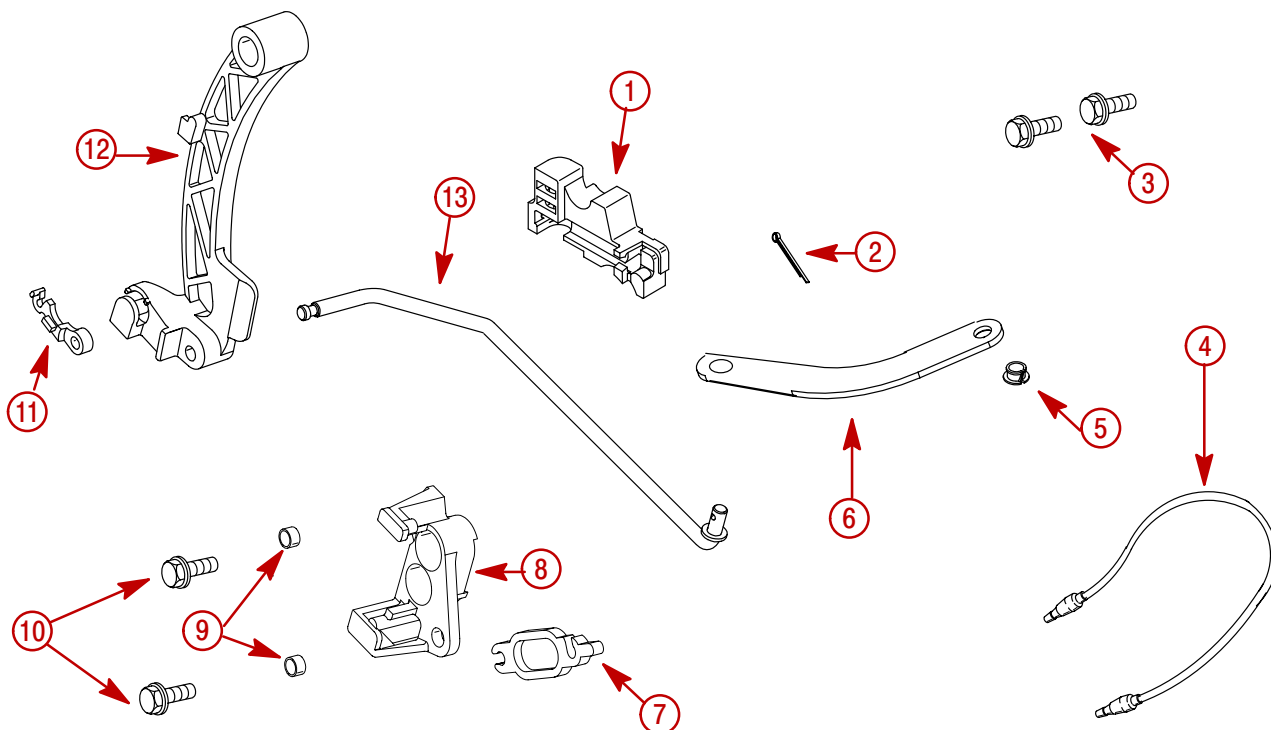

Ref.	Description	Qty.
1	Guide-Shift Rod (850163-1)	1
2	Cotter Pin (18-21071)	1
3	Screw M6 x 13 (10-40011126)	2
4	Jumper Wire (84-11149A52)	1
5	Nyliner (23-48475)	1
6	Shift Link (850255)	1
7	Latch (98889)	1
8	Bracket (827706)	1
9	Sleeve (23-15885)	2
10	Screw M6 x 16 (10-824832--4)	2
11	Retainer (822459)	1
12	Shift Lever (825957--1)	1
13	Shift Rod (850162)	1

## Parts Removal

### Shift Rod, Throttle Bracket, and Tiller Handle Removal

1. Remove lower cowl to ease removal and installation. Refer to service manual.
2. Remove link rod cotter pin (discard) and washer (retain). Slide link rod out of shift slide.
3. Remove shift link nuts and washers (retain 1 nut, 1 washer).
4. Remove shift guide bracket screws. Remove shift guide bracket assembly (includes shift slide) and shift link.
5. Remove the nyliner from the shift link and retain for assembly.

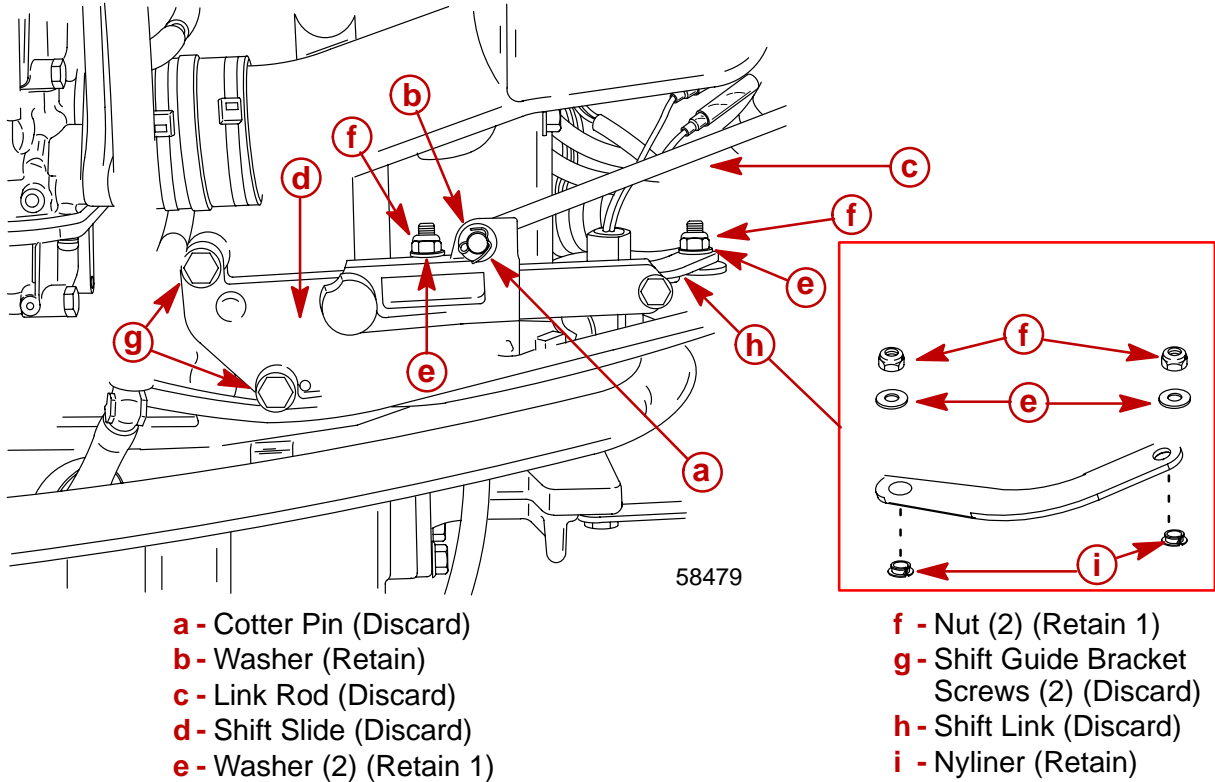

6. Remove neutral safety switch from upper shift shaft bracket.

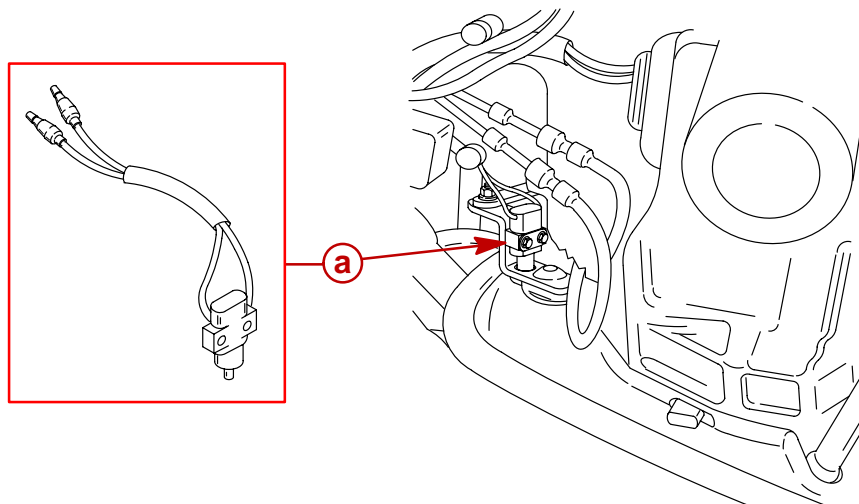

7. Loosen the jam nuts and disconnect the throttle cables from the throttle lever.

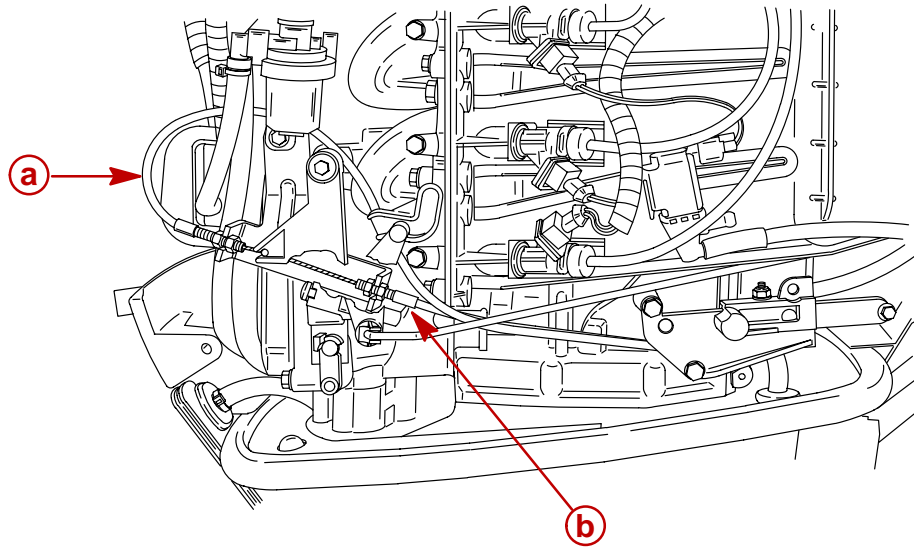

- a** - Throttle Cable (Long)  
**b** - Throttle Cable (Short)

8. Cut cable tie and disconnect the tiller handle wiring.

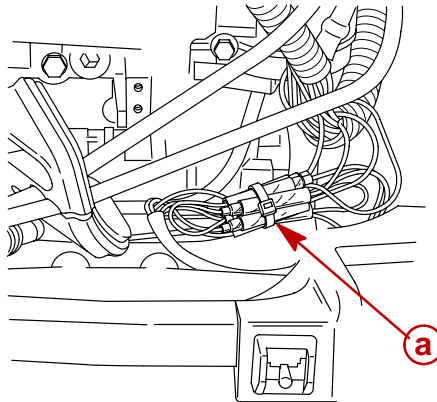

- a** - Cable Tie

9. Remove tiller handle screws, tab washer, and tiller handle.

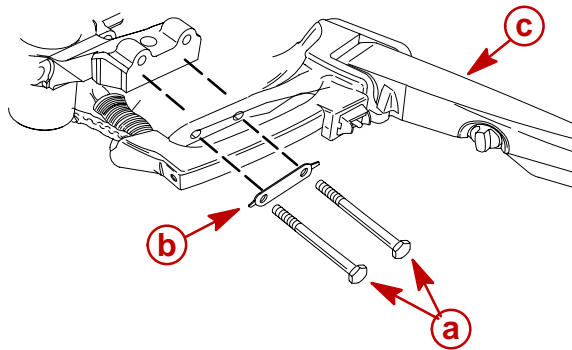

- a** - Screws (2)-M10x90 (Discard)
- b** - Tab Washer (Discard)
- c** - Tiller Handle Assembly (Discard)

10. Remove throttle lever and cable bracket. Retain screws and bushing for reassembly.

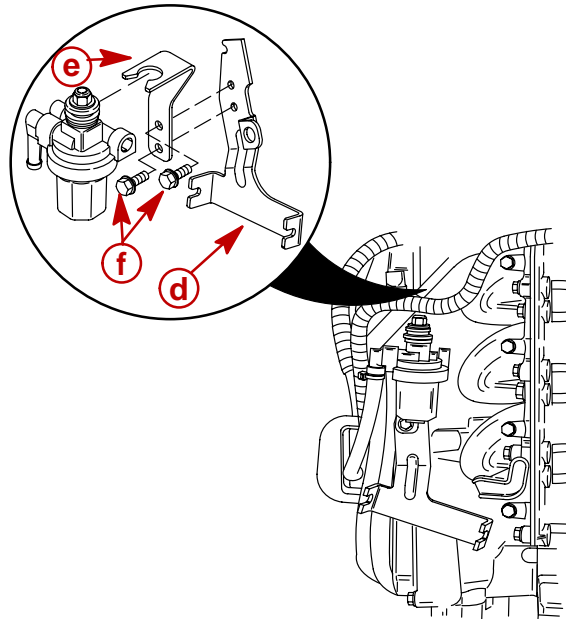
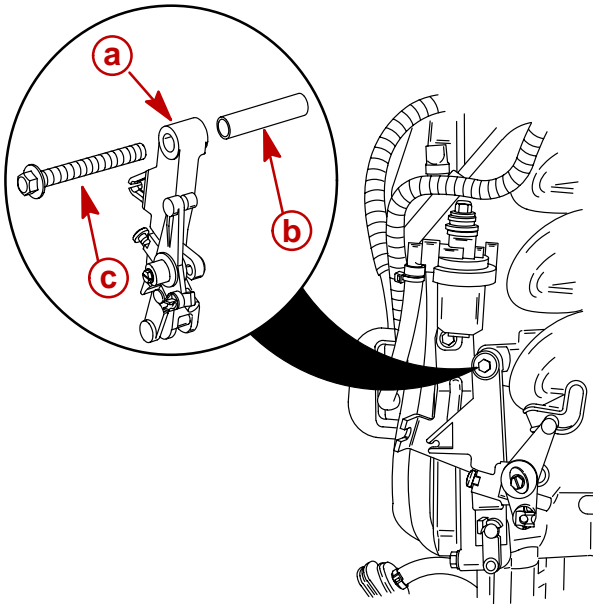

- a** - Throttle Lever
- b** - Bushing
- c** - Screw-M8x70
- d** - Cable Bracket
- e** - Fuel Filter Bracket
- f** - Screws (2)-M6x20

# Installation

## Component Assembly

1. Assemble latch onto cable anchor bracket.
2. Assemble retainer onto shift lever. Slide over boss on back of shift lever, rotate clockwise and snap into place.

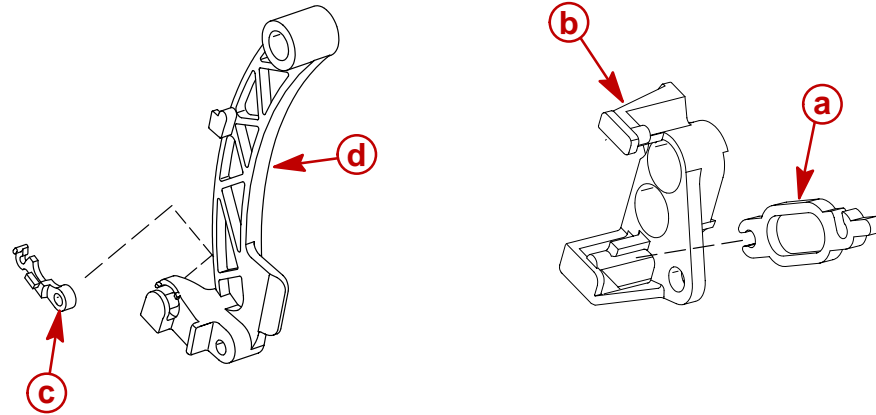

- a** - Latch
- b** - Cable Anchor Bracket
- c** - Retainer
- d** - Shift Lever

3. Install shift rod through the hole in the shift rod guide. Push the rod through the hole and snap it into the locking tabs.

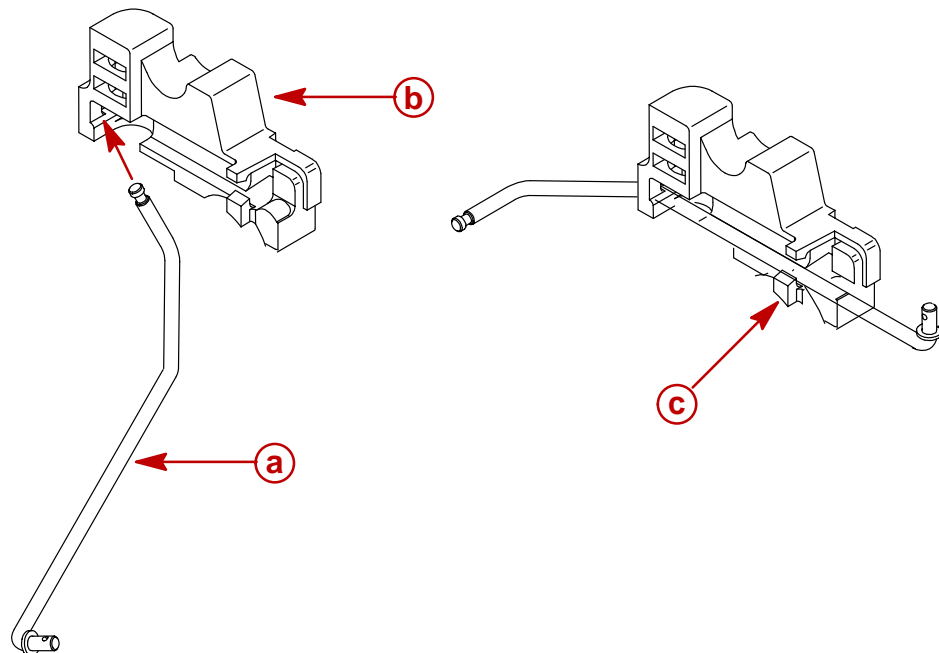

- a** - Shift Rod
- b** - Shift Rod Guide
- c** - Locking Tabs

4. Install shift rod into shift lever as shown.

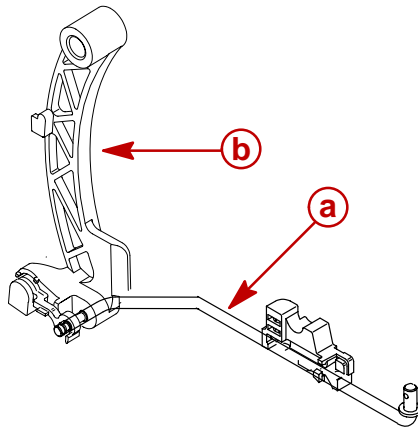

**a** - Shift rod  
**b** - Shift Lever

5. Remove remote linkage parts from side of engine as shown.

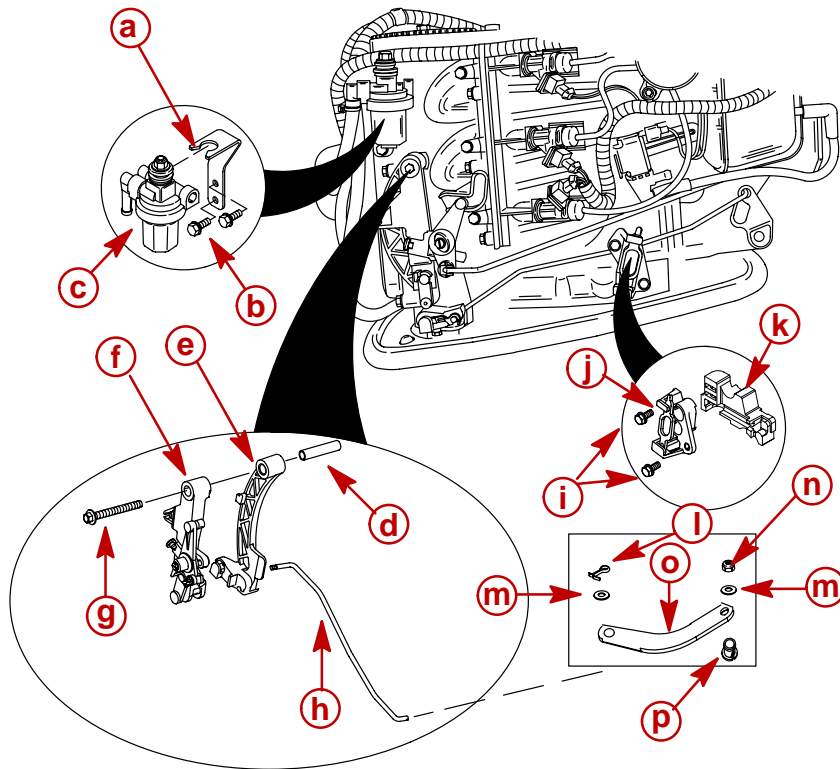

**a** - Fuel Filter Bracket (Retain)  
**b** - Screw (2) M6x13  
**c** - Fuel Filter (Retain)  
**d** - Bushing (Retain)  
**e** - Shift Lever  
**f** - Throttle Lever (Retain)  
**g** - Screw M8 x 70 (Retain)  
**h** - Shift Rod

**i** - Screw (2) M6 x 16  
**j** - Bracket  
**k** - Guide, Shift Rod  
**l** - Cotter Pin  
**m** - Washer(2) (Retain)  
**n** - Nut (Retain)  
**o** - Shift Link  
**p** - Nyliner (Retain)

## Component Installation

1. When installing shift lever assembly make sure the shift rod guide rounded section fits underneath the cable anchor bracket upper bolt boss.

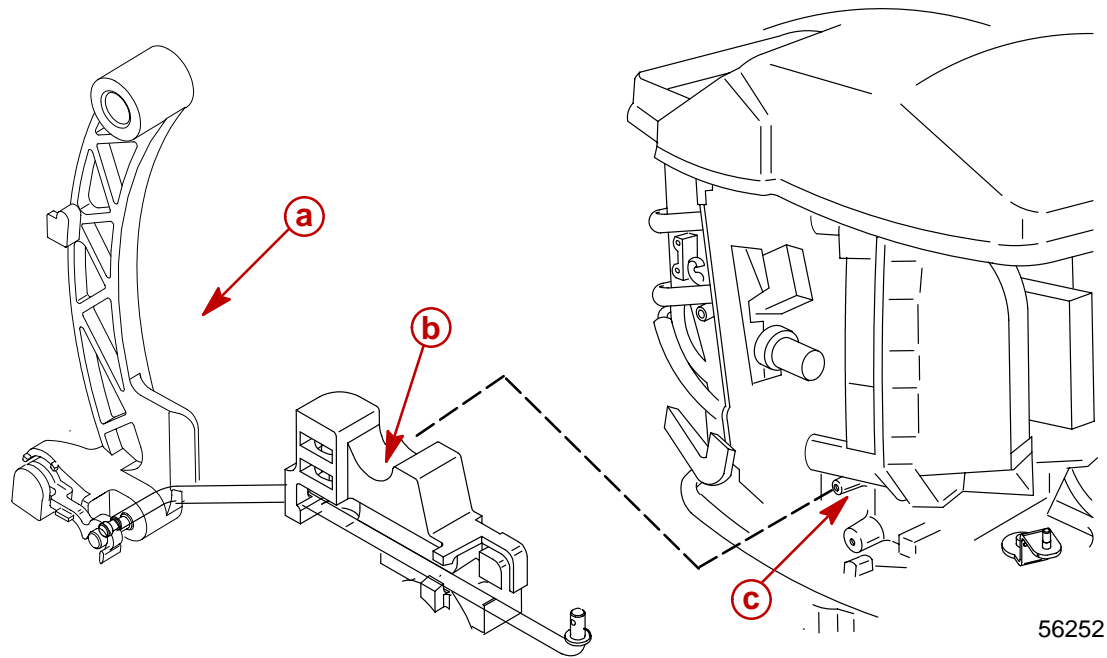

56252

- a** - Shift Lever Assembly
- b** - Shift Rod Guide Rounded Section
- c** - Upper Bolt Boss

2. Install throttle lever and shift lever as shown. Apply 2-4-C with Teflon to bushing and tighten screw to specified torque.
3. Install cable anchor bracket as shown. Sleeves can be drawn into the bracket while tightening the screws or pressed in using suitable mandrel.

**NOTE:** If pressing in sleeves place the bracket flange on a flat surface. Without support under the flange damage to the bracket may occur during the press operation.

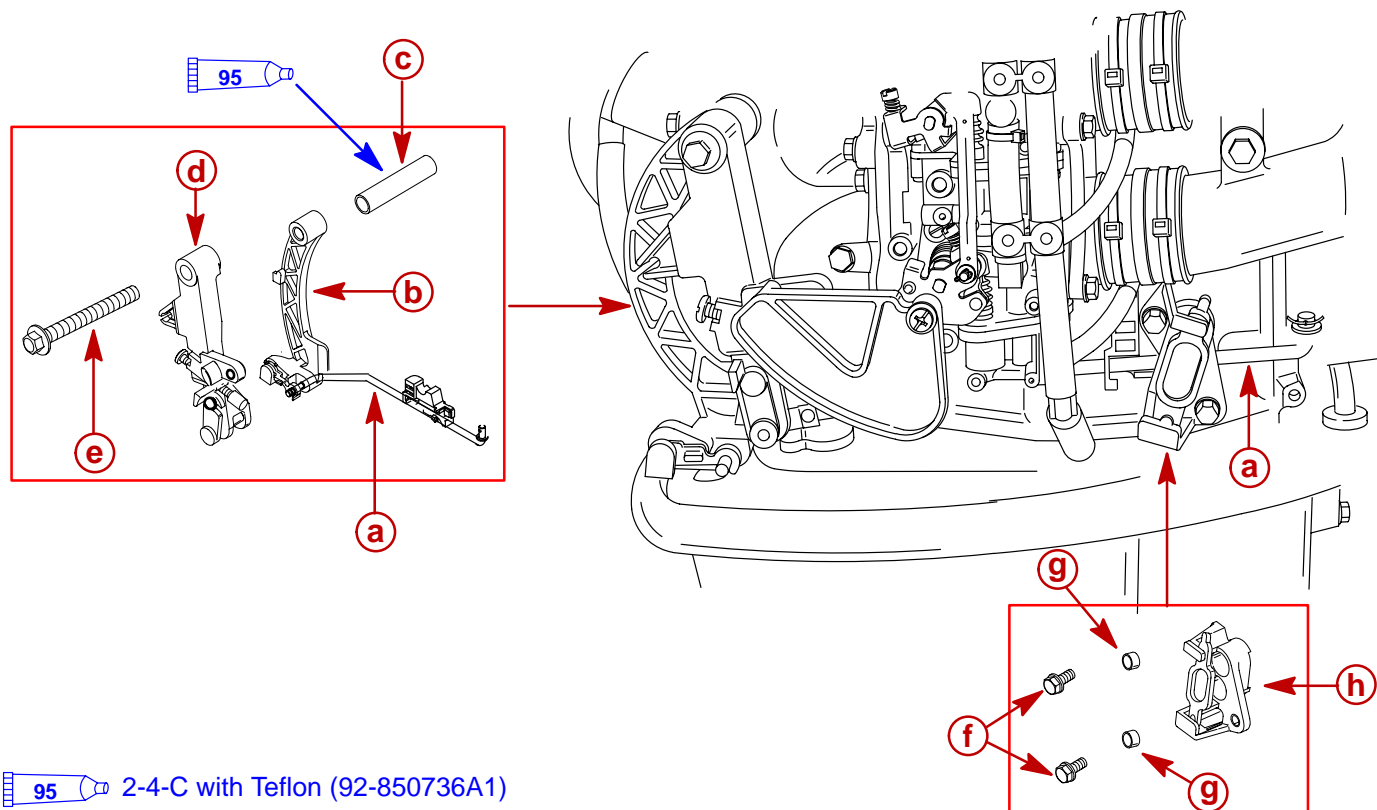

95 2-4-C with Teflon (92-850736A1)

- a - Shift Rod
- b - Shift Lever
- c - Bushing (Retained)
- d - Throttle Lever (Retained)

- e - Screw - M8x70 (Retained)
- f - Screw (2) M6x16
- g - Sleeve
- h - Cable Anchor Bracket

Throttle Lever Screw Torque
100 lb-in. (11.3 Nm)
Cable Anchor Bracket Screw Torque
75 lb-in. (8.5 Nm)



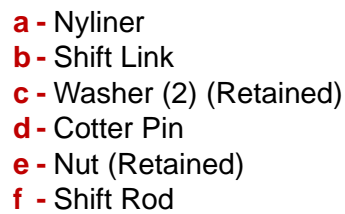

# Wiring Harness

## Electric Start Models

1. Route remote control wiring harness into bottom cowl, connect wiring, and place harness into the holder.
2. Connect wiring. Push the wiring harness connectors together inside the rubber sleeve. Push the retainer over the exposed ends of the connectors. This will hold the connectors together.
3. Connect yellow/red jumper wire where neutral start switch was removed.

# REMOTE CONTROL ELECTRIC START WIRING DIAGRAM-50/60 (4-STROKE)

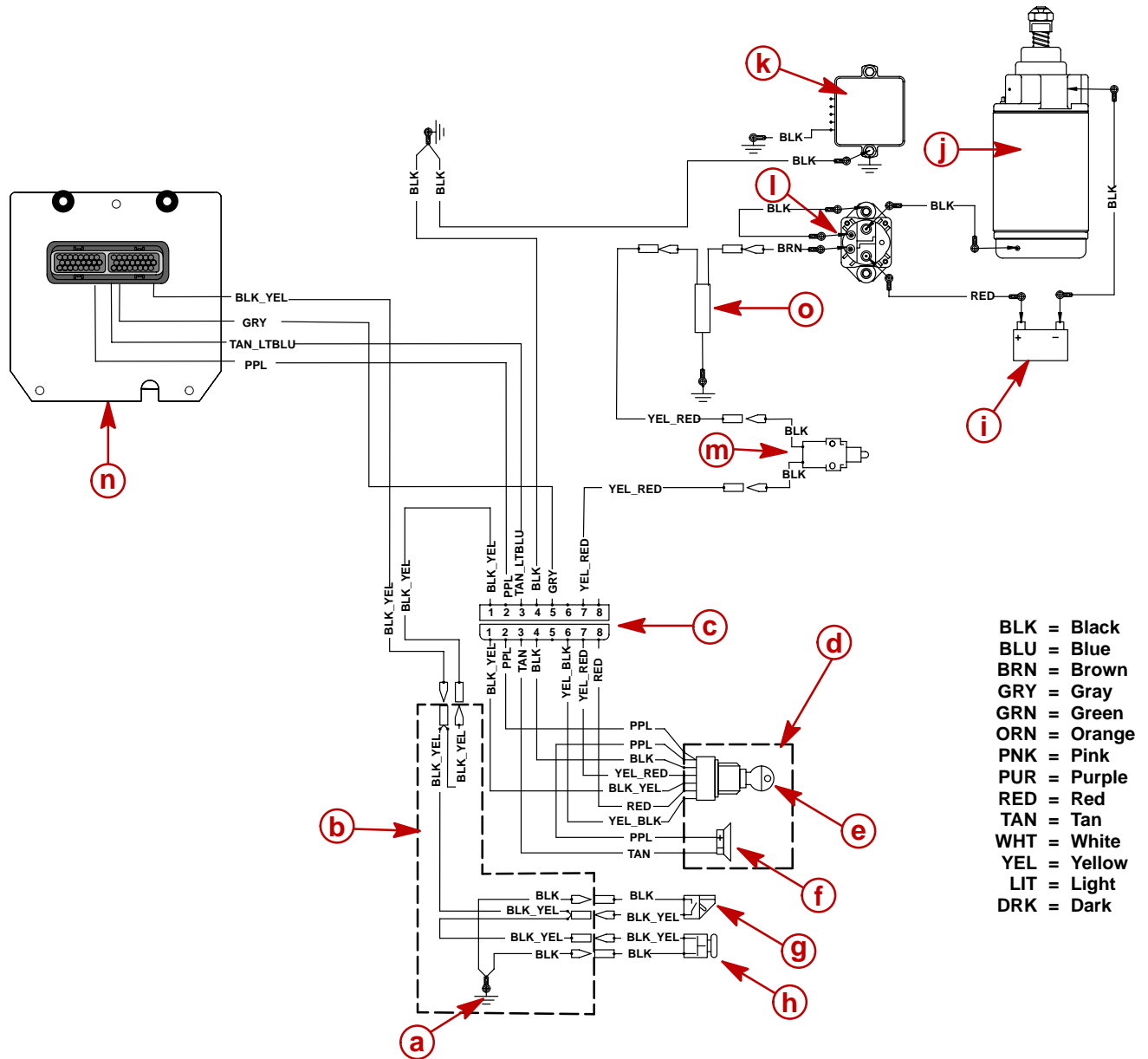

- a** - Ground Harness below Starter Motor M6x16 screw
- b** - Harness Extension
- c** - Harness Connection
- d** - Key Switch Assembly Transom Mount
- e** - Key Switch
- f** - Horn
- g** - Lanyard Stop Switch

# Shift and Throttle Cable Installation

Install cables into the remote control following the instructions provided with the remote control.

**NOTE:** Install the shift cable to the engine first. The shift cable is the first cable to move when the remote control handle is moved out of neutral.

## Shift Cable Installation

1. Position remote control into neutral.
2. Remove access cover from side of bottom cowl.

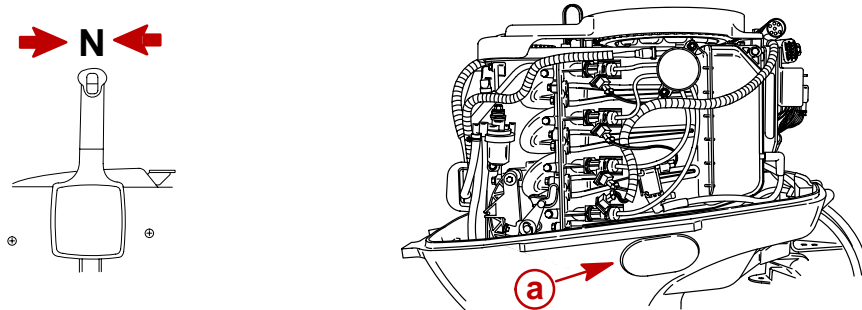

**a** - Access Cover

3. Shift outboard into neutral.
4. Measure the distance (a) between pin and center of lower hole.

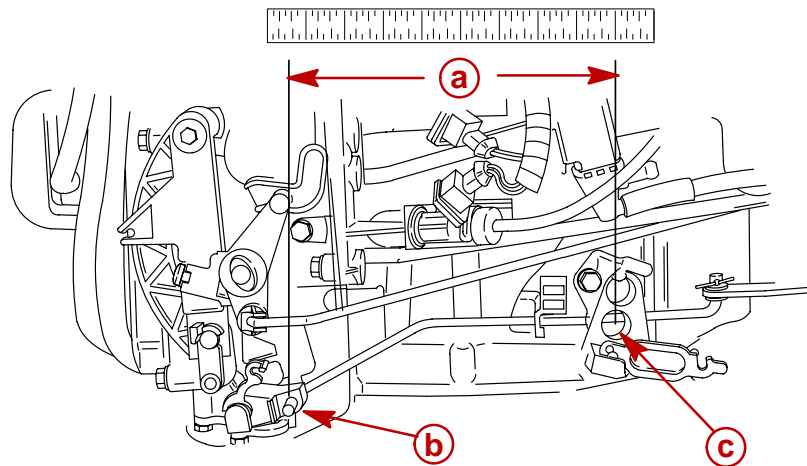

**a** - Distance Between Pin And Center of Lower Hole

**b** - Pin

**c** - Lower Hole

5. Fit shift cable through rubber grommet.

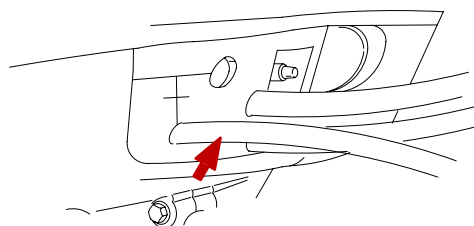

6. Push in on the cable end until resistance is felt.

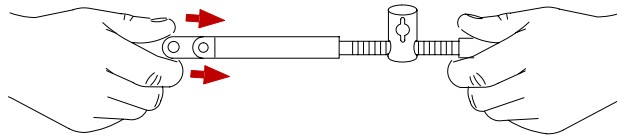

7. While pushing in on the cable end, adjust the cable barrel (b) to attain the measured distance (a) taken in Step 3.

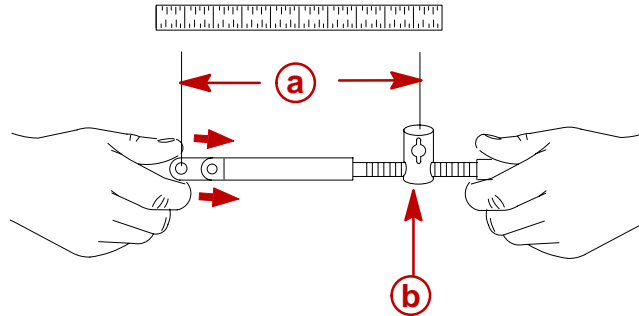

**a** - Adjust Cable Barrel To Attain The Measured Distance Taken In Step 3

**b** - Cable Barrel

8. Place cable barrel into the barrel holder. Fasten cable with retainer.

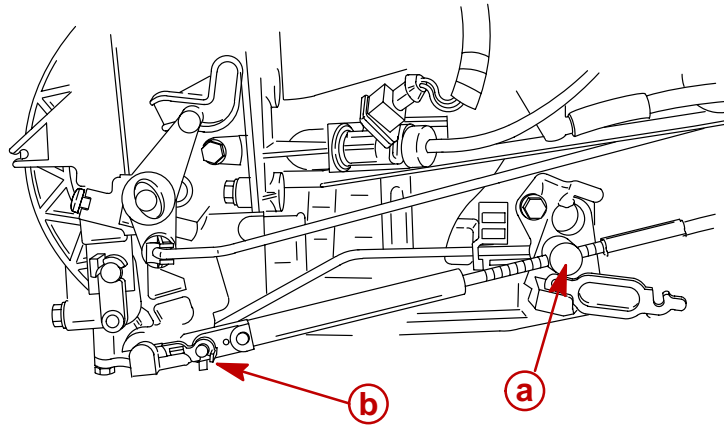

**a** - Place Barrel Into Barrel Holder

**b** - Retainer

9. Check shift cable adjustments as follows:
- Shift remote control into forward. The propeller shaft should be locked in gear. If not, adjust the barrel closer to the cable end.
  - Shift remote control into neutral. The propeller shaft should turn freely without drag. If not, adjust the barrel away from the cable end. Repeat steps a and b.
  - Shift remote control into reverse while turning propeller. The propeller shaft should be locked in gear. If not, adjust the barrel away from the cable end. Repeat steps a thru c.
  - Shift remote control back to neutral. The propeller shaft should turn freely without drag. If not, adjust the barrel closer to the cable end. Repeat steps a thru d.

## Throttle Cable Installation

1. Position remote control into neutral.

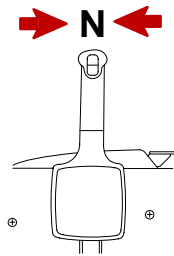

2. Fit throttle cable through rubber grommet.

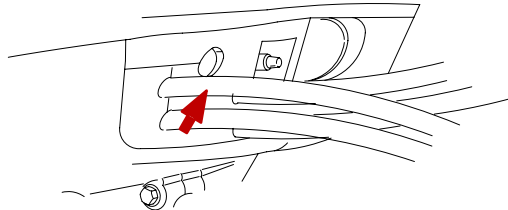

3. Install throttle cable with retainer pin. Lock retainer pin in place.
4. Place throttle cable onto the throttle lever pin. Lock in place with retainer.

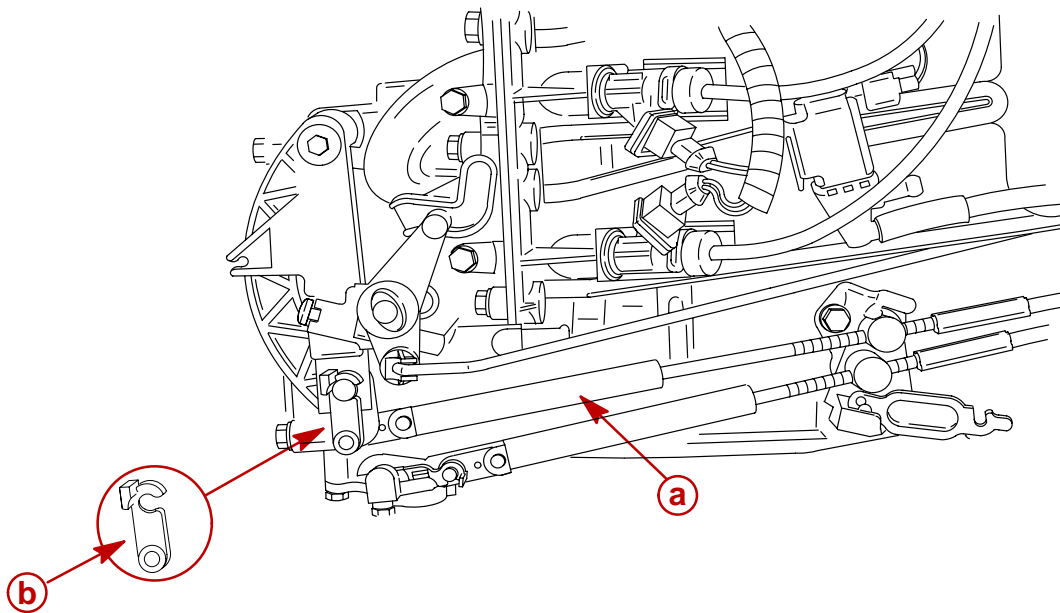

**a** - Throttle Cable  
**b** - Retainer

5. Adjust cable barrel until the center of the roller lines up with the alignment mark on the cam.

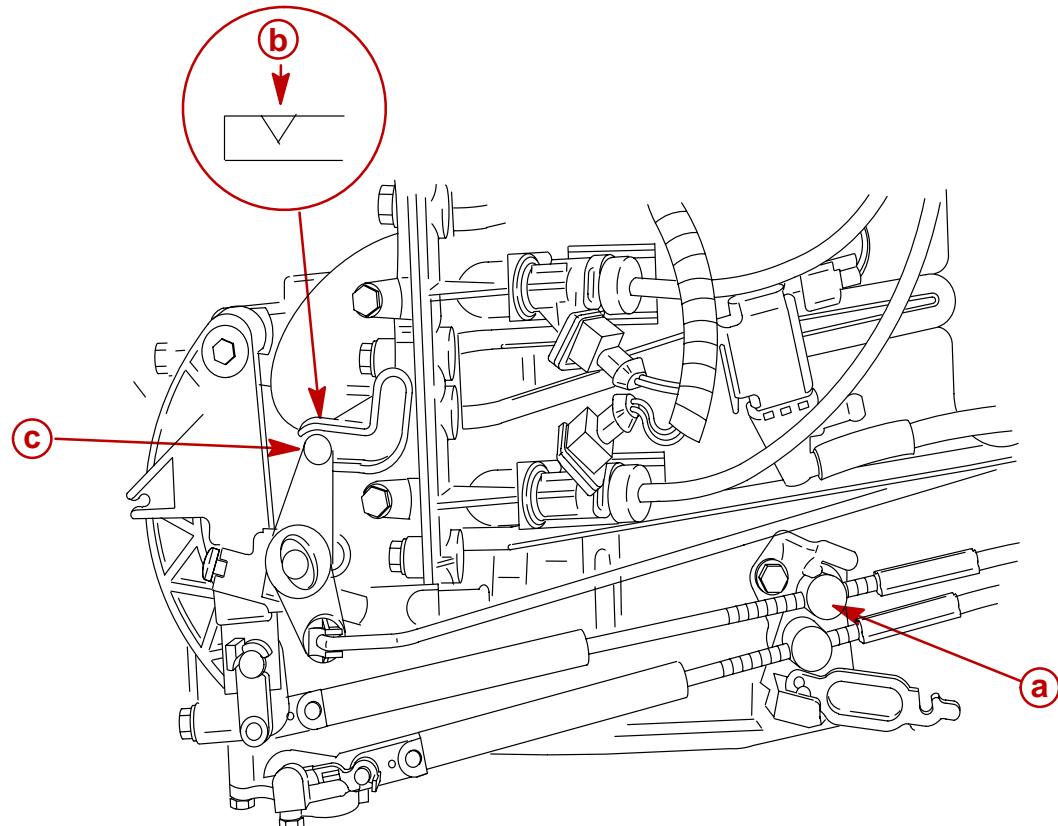

**a** - Cable Barrel  
**b** - Alignment Mark  
**c** - Roller

6. Fasten control cables with the cable latch.

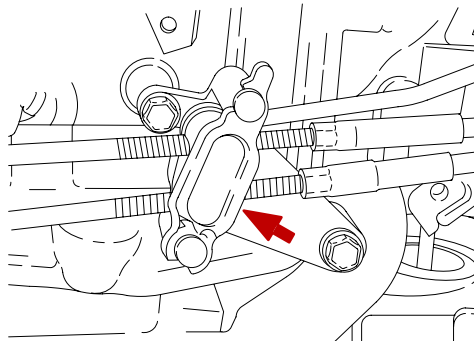

7. Install the access cover.

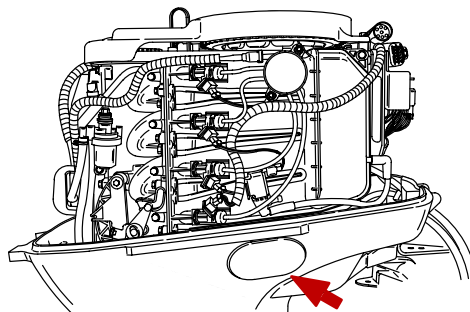

## Steering Friction Adjustment

1. Remove or disable co-pilot components when installing remote steering.

