

# 858566A02

## COASTAL FLUSH KIT

### Components Contained In Kit

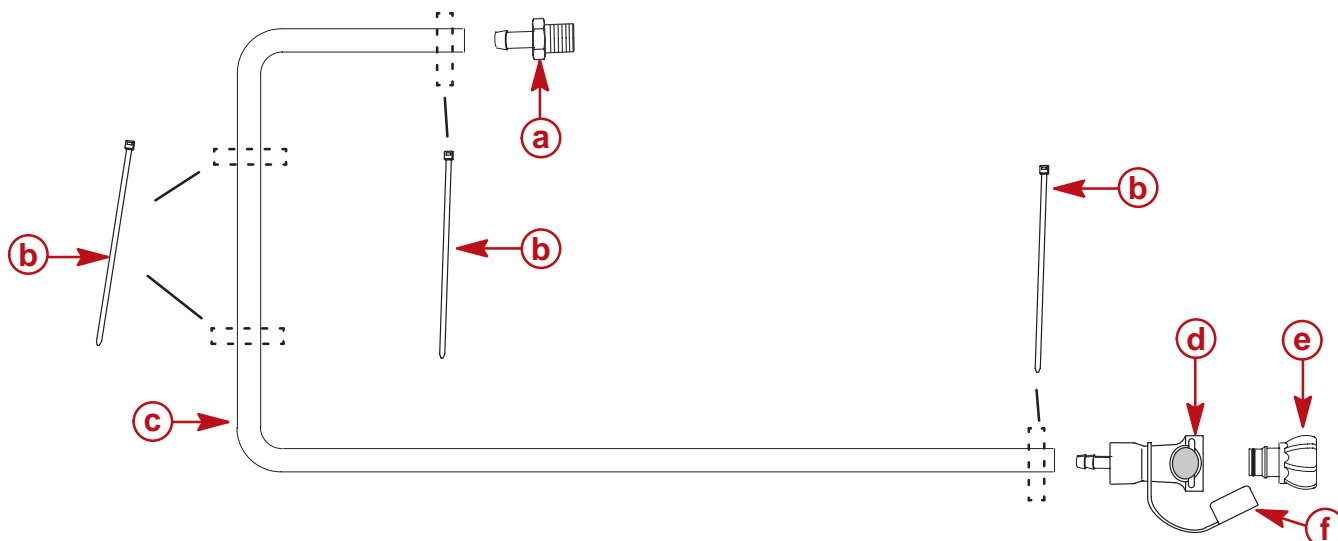

REF.	QTY.	DESCRIPTION	PART NUMBER
a	1	FITTING* - STRAIGHT, BARB	22-835454001
b	4	CABLE TIE	54-816311T
c	1	HOSE (43 IN. [109 CM])	32-830757130
d	1	COUPLING - FLUSH CONNECTOR	22-857176
e	1	COUPLING - HOSE ADAPTOR	22-857175
f	1	CAP - DUST COVER	19-858240

\*Special Barb Fitting – This fitting has been restricted to a 1/8 in. opening. Never replace this fitting with a standard type (non-restricted) barb fitting. See Caution below.

#### **CAUTION**

**Prevent water pressure gauge damage. Use only the special restricted barb fitting provided with this kit. The restriction in the fitting is required to limit the water pressure while flushing the engine. Unrestricted water pressure can damage a water pressure gauge. DO NOT flush engine using a water system that exceeds 310 kPa (45 psi).**

# Installation

## Cowl Clamp Modification

1. Remove top engine cowl. Pull up the cowl seal and remove the upper clamp from the bottom cowl. Leave lower clamp in place.
2. Using needle nose pliers, carefully break out semi-circular knockout section of plastic on the upper and lower clamp. The area to be removed is thinner than the surrounding material and is marked by a depression on inside of both clamp pieces.
3. Smooth knockout edges on clamp with sandpaper or a small knife.

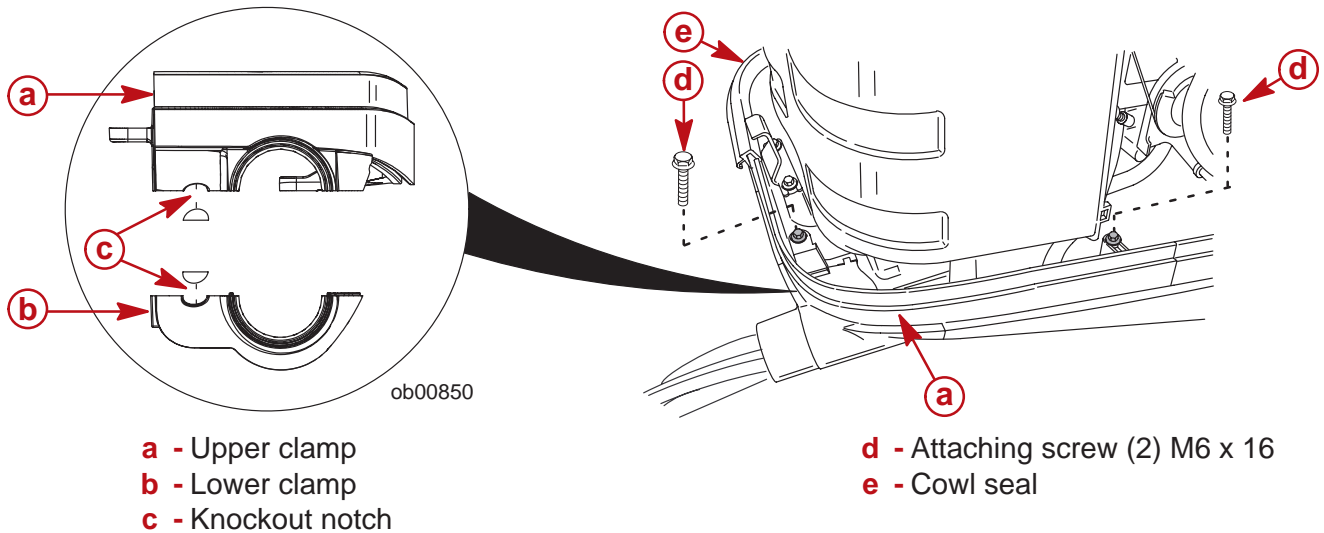

## Hose Installation

1. Remove plug from rear cover on engine.
2. Thread supplied barb fitting into cover.
3. Connect flush hose to the barb fitting. Fasten hose to fitting with cable tie.

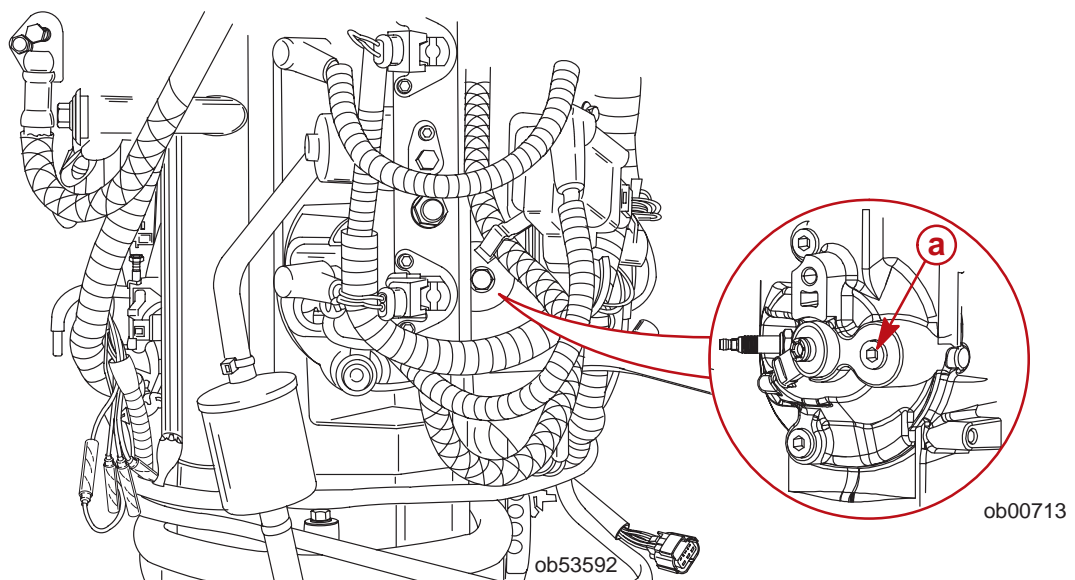

Aft View

**a** - Plug

4. Route hose along the port side of engine and over lower clamp.

**IMPORTANT: Ensure that hose is routed and fastened so it will not interfere with the rear cowl latch.**

5. Cut hose to the desired length.
6. Connect hose to the flush connector. Fasten with sta-strap.
7. Fasten the flush hose with 2 cable ties along side of the wire harness or cables.

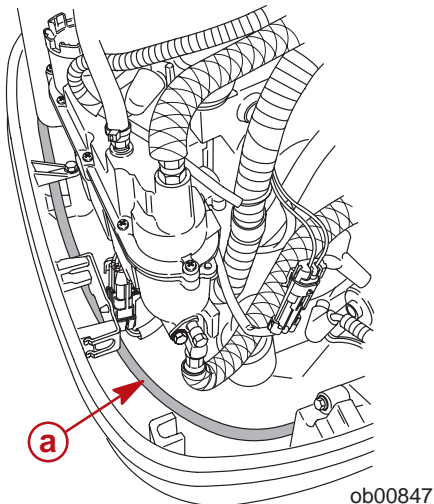

- a** - Flush hose
- b** - Lower clamp - notch
- c** - Cable tie

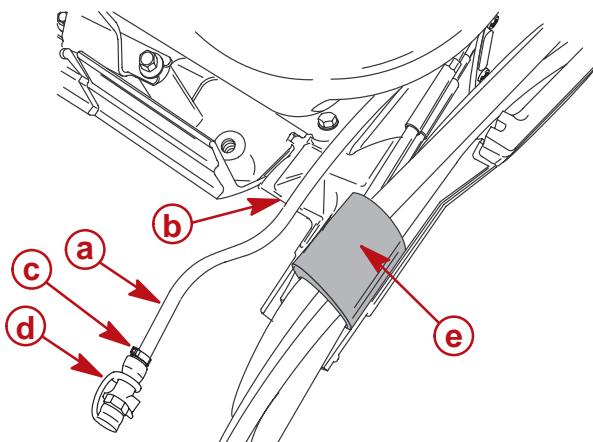

- d** - Flush connector
- e** - Neoprene wrap

8. Place the flush hose over the notched out section of the lower clamp.
9. Ensure that the neoprene wrap is properly installed around the wiring, hoses, and control cables. Reinstall the upper clamp and cowl seal. Attach upper clamp with 2 screws. Torque to 7.3 Nm (65 lb-in.).

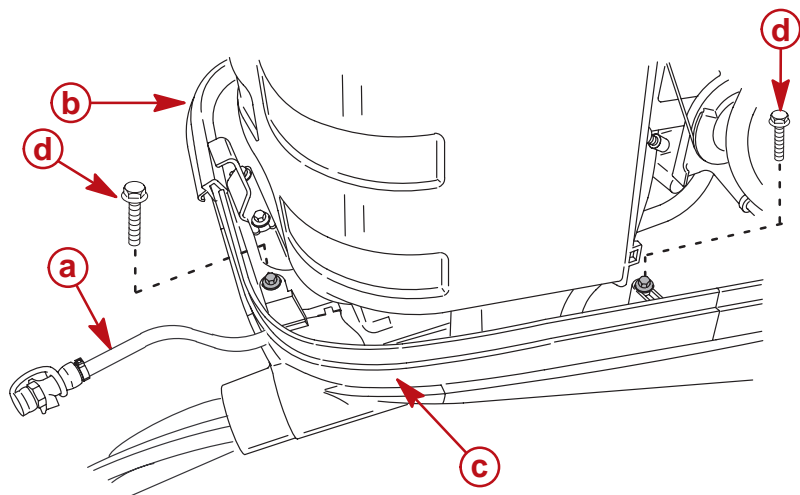

- a** - Flush hose
- b** - Cowl seal

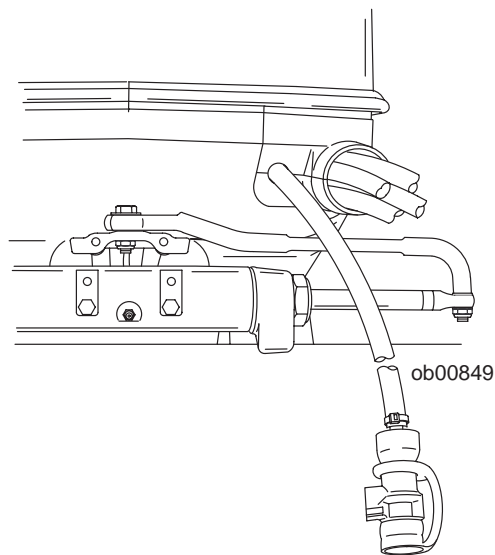

- c** - Upper clamp
- d** - Screw (2) M6 x 16

10. Install top cowl.

# Flushing the Cooling System

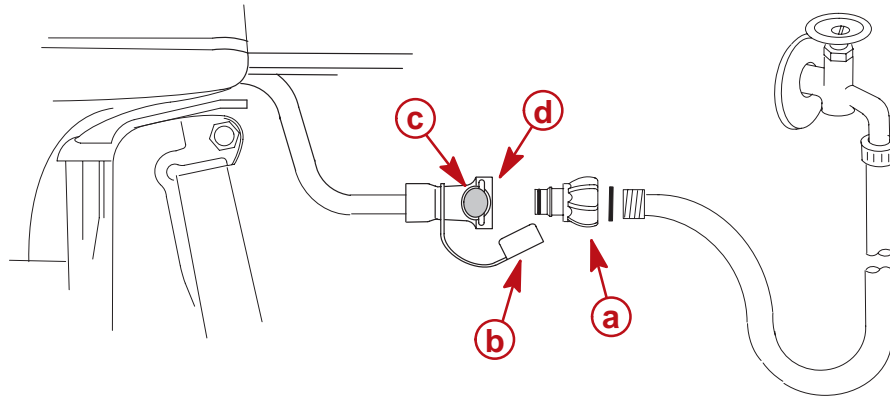

- a** - Hose adapter
- b** - Dust cover
- c** - Release button
- d** - Flush connector

**IMPORTANT: DO NOT flush engine using a water system that exceeds 310 kPa (45 psi).**

Flush the internal water passages of the outboard with fresh water after each use in salt, polluted, or muddy water. This will help prevent a buildup of deposits from clogging the internal water passages.

1. Thread a water hose into hose adaptor.
2. Remove dust cover and push the hose adaptor into the flush connector until it locks (snaps) in place.
3. Turn on the water and flush the cooling system for a minimum of 3 minutes.

**NOTE:** Engine can be stopped or running at idle speed in neutral when flushing the cooling system.

4. Push button in to release the hose adaptor. Reinstall the dust cover.

**NOTE:** The hose adaptor shuts off the water flow whenever it is disconnected from the flush connector.

## FREEZING TEMPERATURE

The water should be drained out of the engine flush hose If there is a chance of freezing temperature. Drain water as follows:

Remove water hose from the hose adaptor. Insert the hose adaptor only into the flush connector. Tilt the outboard up until all the water has drained out of the hose.